



Operations at a Meatpacking Plant

Meat Packing as a Model Railroad Industry

Mat Thompson

Paul Dolkos photo courtesy of Model Railroader

In the beginning

Paul Dolkos

– Working the Mill Job

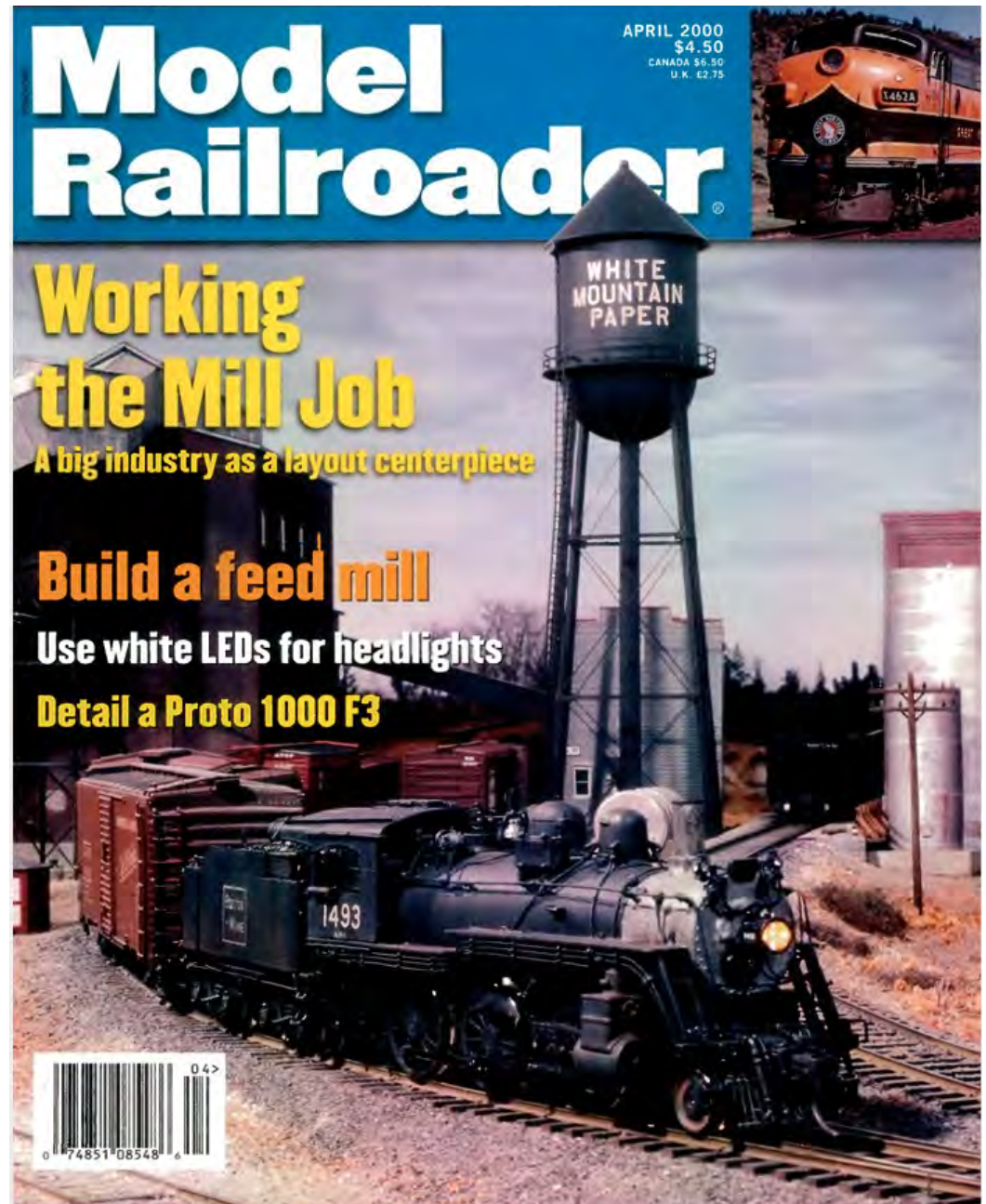

Inspiration for Swift

Doug Harding 2-part article
“Modeling a Meat Plant and Its
Operations”

Swift plant in north Portland





Branch House (steam & transition era)

- Hundreds across nation - Stock pens not common
- Normally single-track industry
- Meat received in parent company reefers or leased cars
- Inbound - hanging meat
- Outbound – cut meat by trucks





Meat Packing Plant (steam & transition era)

- Large cities (to include Baltimore, Harrisburg, Pittsburgh, New Haven)
- Multi-track large industry co-located with stockyards
- Cows, sheep, hogs received by railroad stock cars
- Parent company reefers or leased cars
- Possible rail Inbound - hanging meat
- Outbound rail – hanging meat, canned meat and by-products



Big Industry

- Walthers modules, Campbell stock pens
- Traffic - holds 12-18 cars - multiple car types
- Space is 9' by 2'
- Requires 2 operators for entire ops session

Swift & Company Is Diversified

Country Produce Plant

Meat Packing Plant

Wholesale Branch House

Poultry

Cheese

Ham

Car Route Sales

Bacon

Eggs

Sliced Bacon

Lamb

Beef

Veal

"Silverleaf" Lard

Ice Cream

Butter

Pork Sausage

Pork

Premium Frankfurts

Soap Flakes

Soap Chips

Washing Powder

Washing Powder

Cleanser

Shampoo

Gelatin

Peanut Butter

Canned Vegetables

Canned Fruits

Salad Oil

Margarine

Sausage Ready-to-serve Specialties

Wool

Hides

Animal Feed

Fertilizer

Plant Food

Shortening and Salad Oil Plant

Cotton Oil Mill

Diversification Promotes Stability

Swift & Company
Is Not Dependent on the Results
of Any One or Any Two Products

Products

The Oregon Coast Railroad

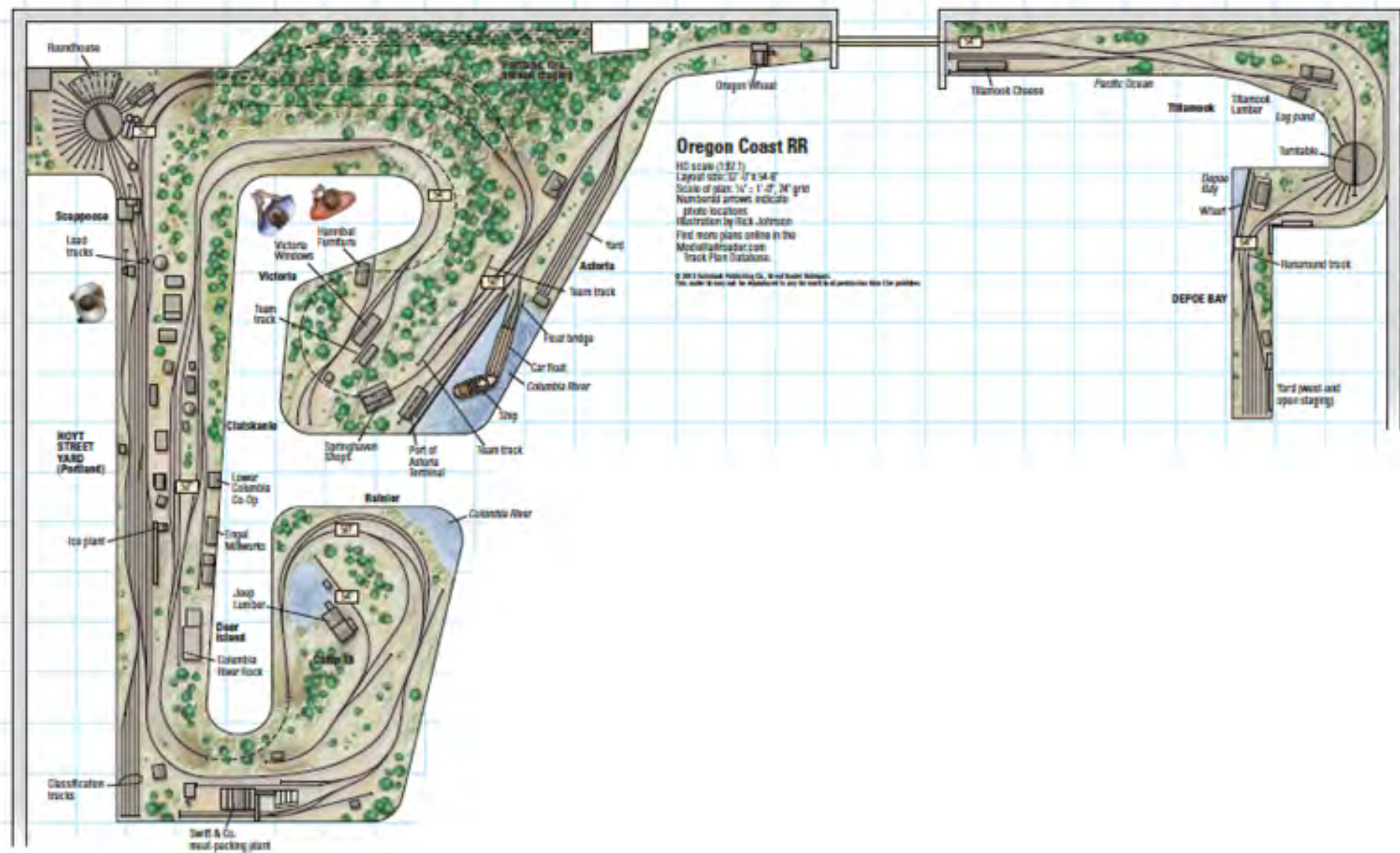

The Oregon Coast Railroad



Bernard Kempinski photo



First Version



Second Version



Second Version



Paul Dolkos photo courtesy of Model Railroader

Third Version



Paul Dolkos photo courtesy of Model Railroader

Swift Traffic:

Refrigerator Cars

- Inbound iced reefers to the cooling track
- Cooled reefers to plant Track 1 doors for loading
- Outbound loaded reefers

Stock Cars

- Inbound loaded 40-foot and 50-foot cars
- Outbound empty stock cars

Tank Cars

- Inbound fuel oil to fuel rack
- Inbound propane to propane tank
- Inbound vegetable oil to Track 2 Door 3
- Inbound empty for animal by-products to Track 2 Door 3
- Outbound empty fuel oil, propane and vegetable oil cars and loaded animal by-products car

Box Cars

- Inbound packing materials and equipment to Track 2 Doors 5, 6, 7
- Inbound empty hide car to Track 2 Door 4
- Outbound loaded hide car
- Outbound canned meats
- Outbound empty boxcars

Third Version



Fourth Version



Fourth Version - Additions



Oregon Coast Railroad Swift Plant - 1957

Swift & Company Is Diversified



Products

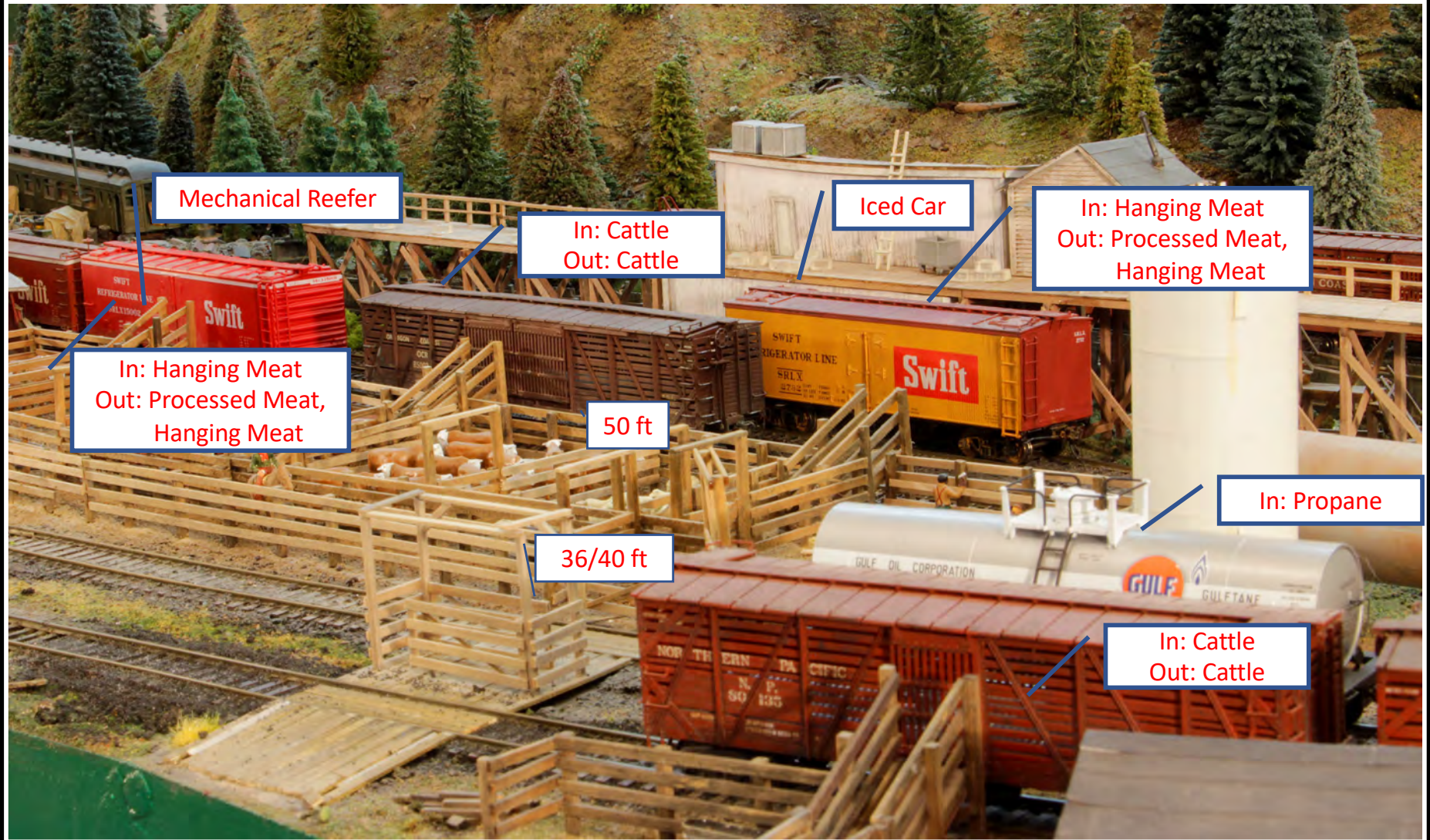

Products and Cars



Products and Cars

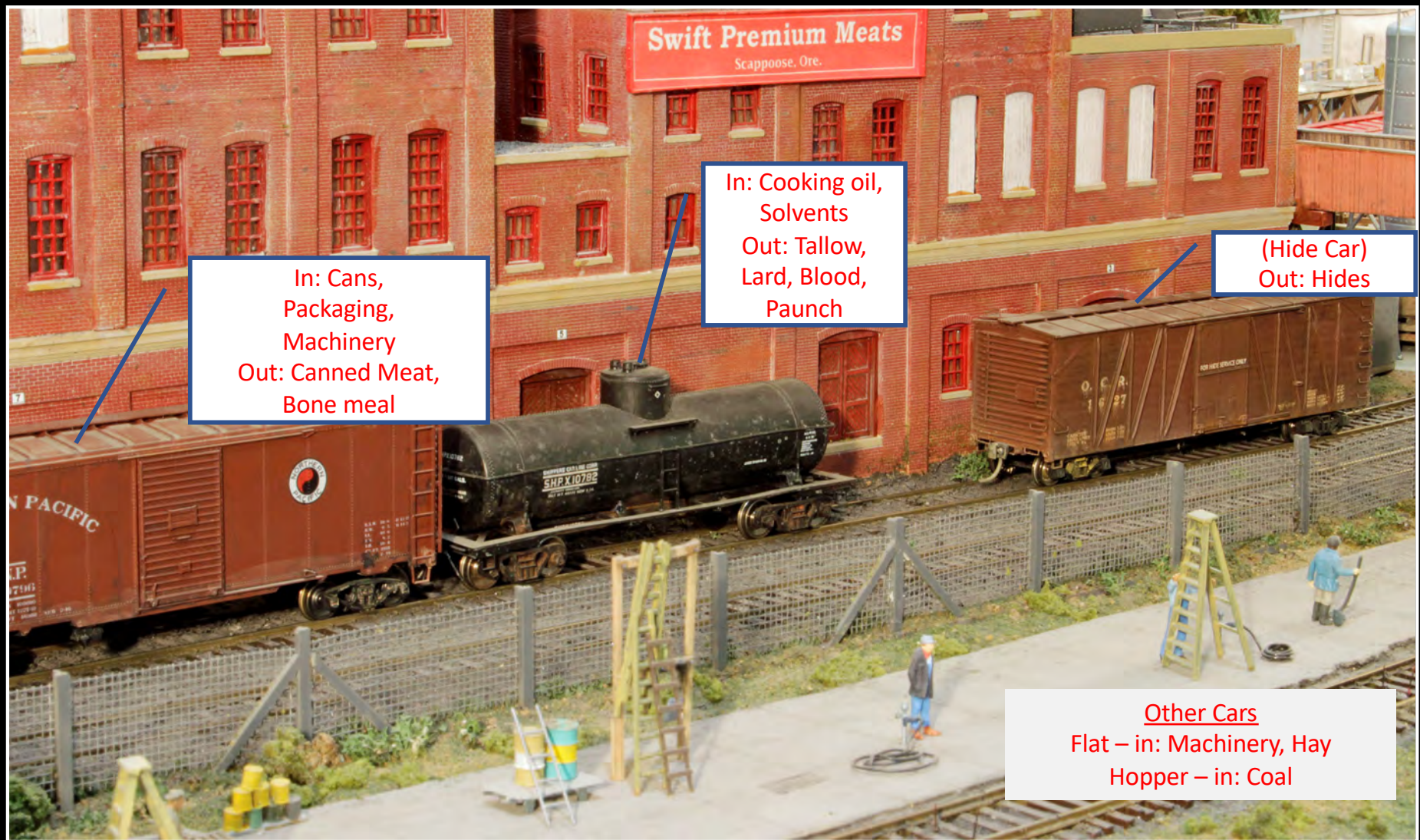

Products and Cars



2 ½ Stock Cars = 1 Reefer

15 – 20 Stock Cars = 1 car per by-product

Car Ratios
(Cattle packing plant - 2000 head daily)

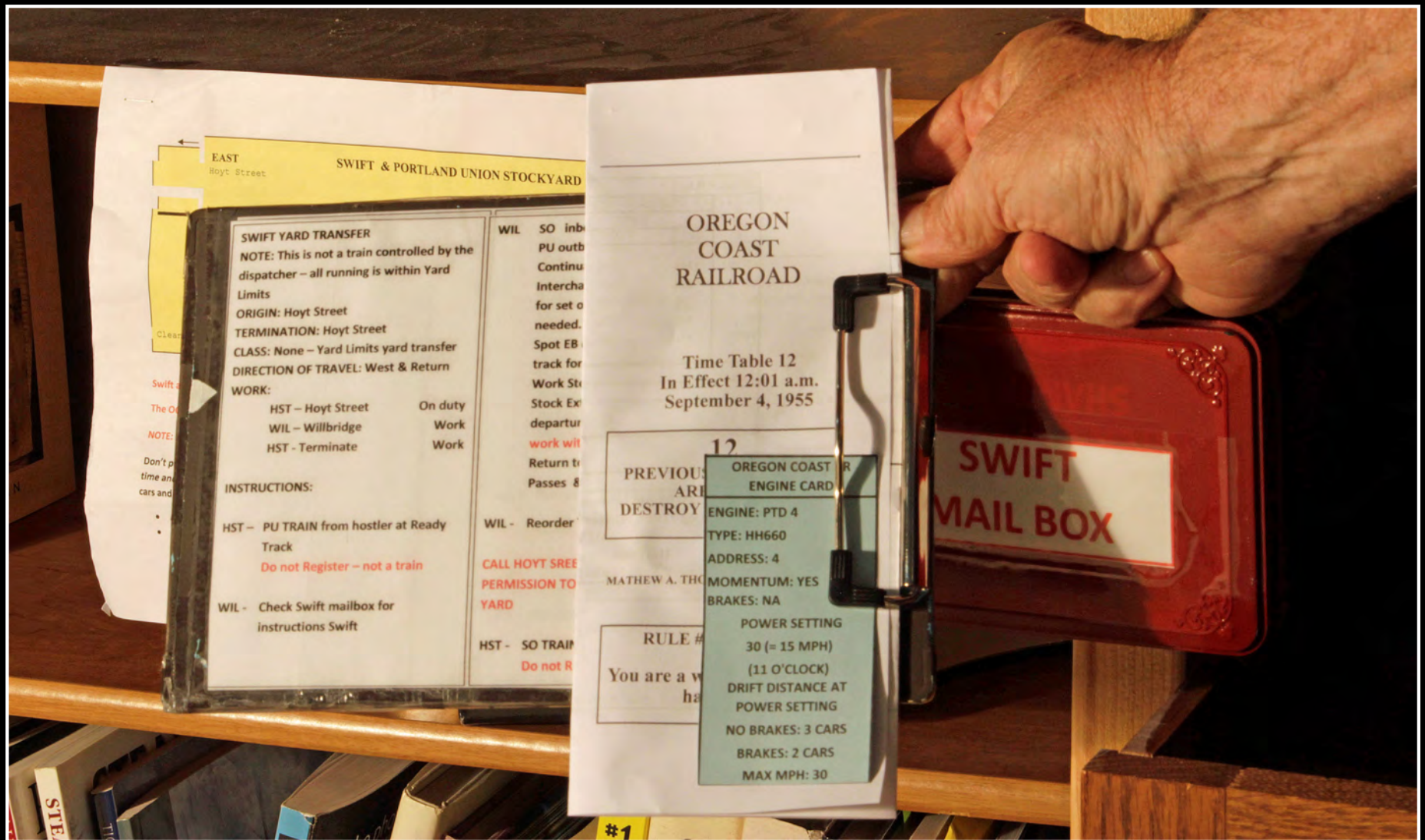

Job Description



Operating Scheme – Yard Transfer

The Oregon Coast Railroad



Bernerd Kempinski photo

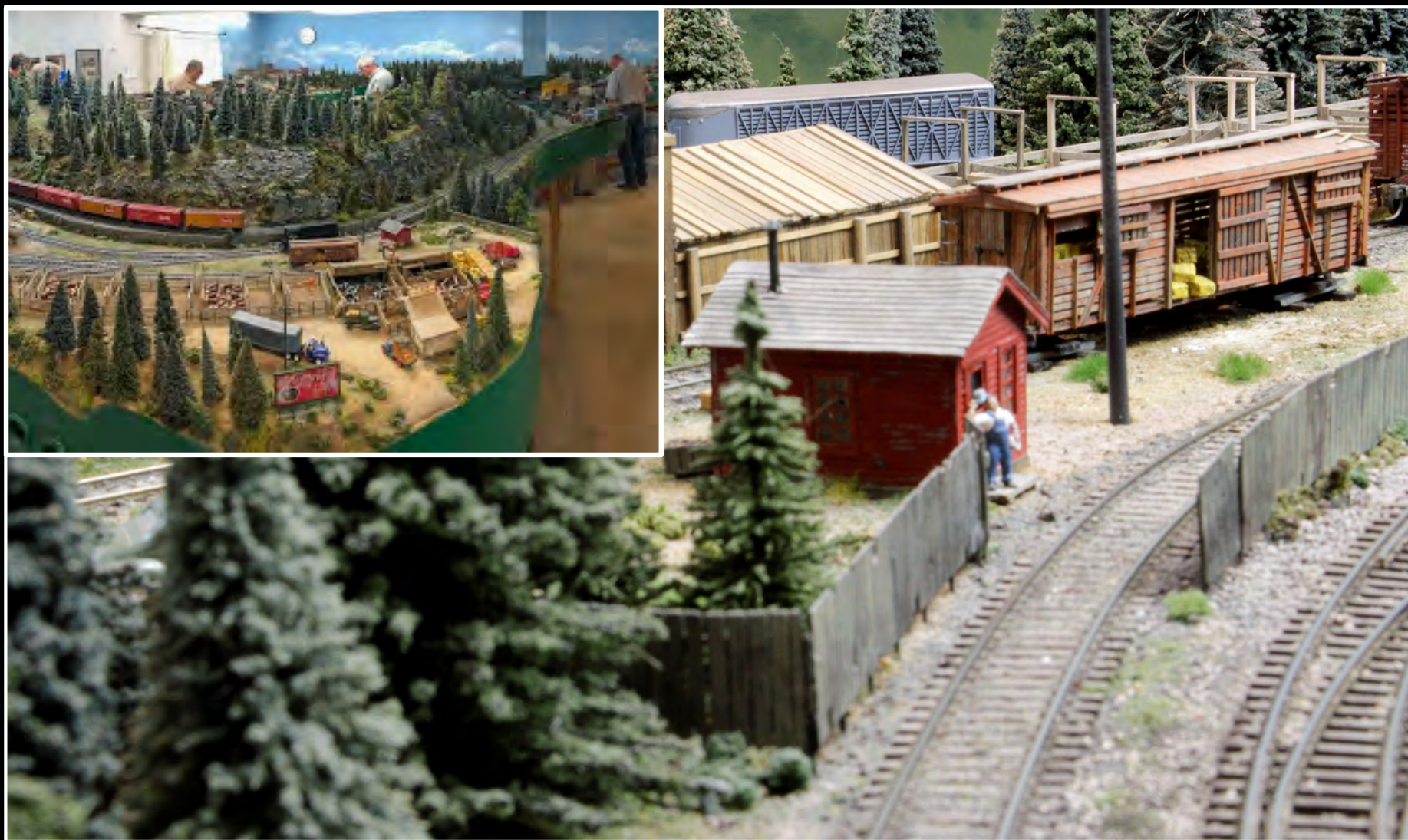

The Mailbox (thanks Lance)



The Mailbox (thanks Lance)



Operating Scheme – Backing In

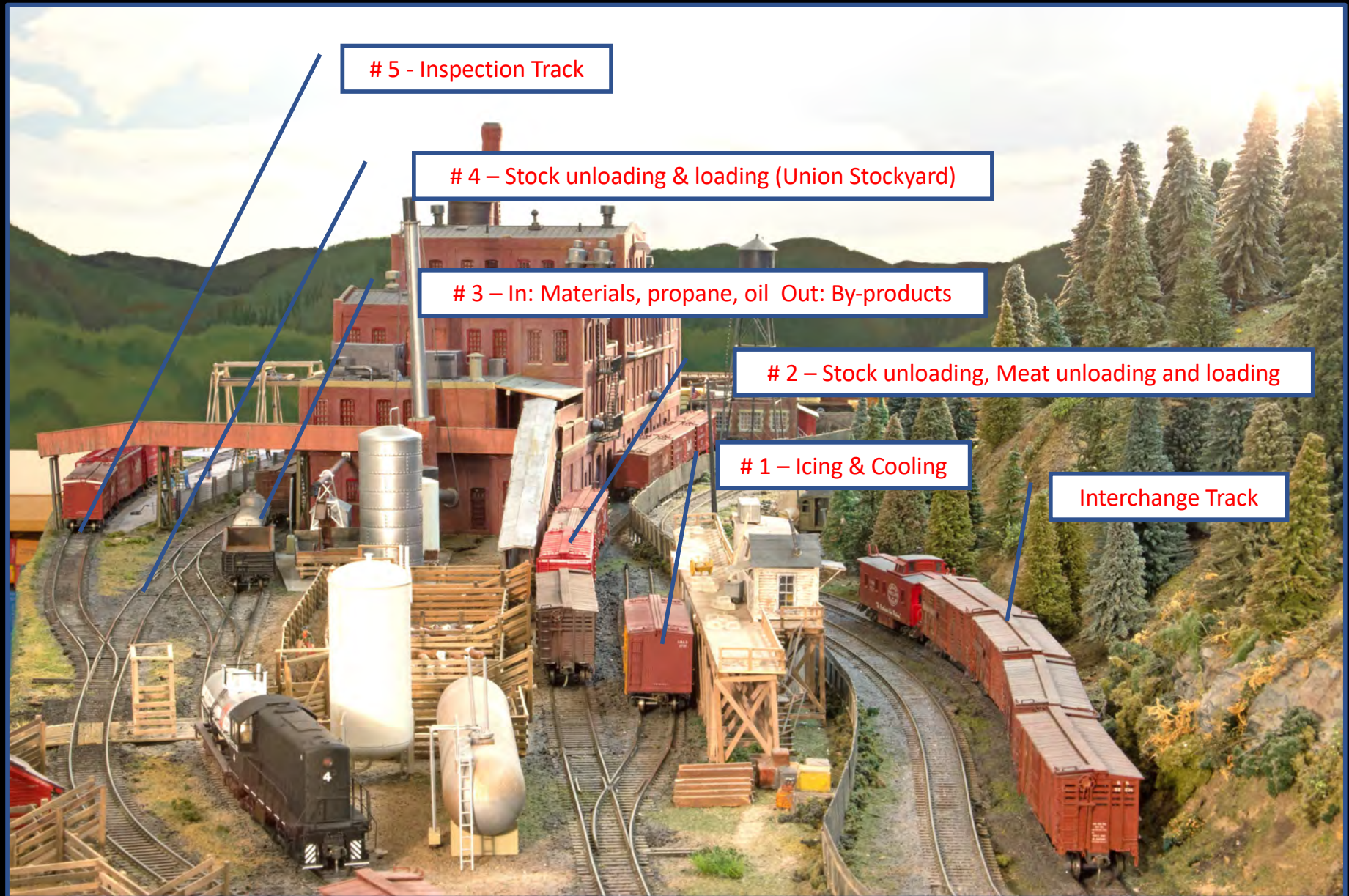

Operating Scheme - Tracks

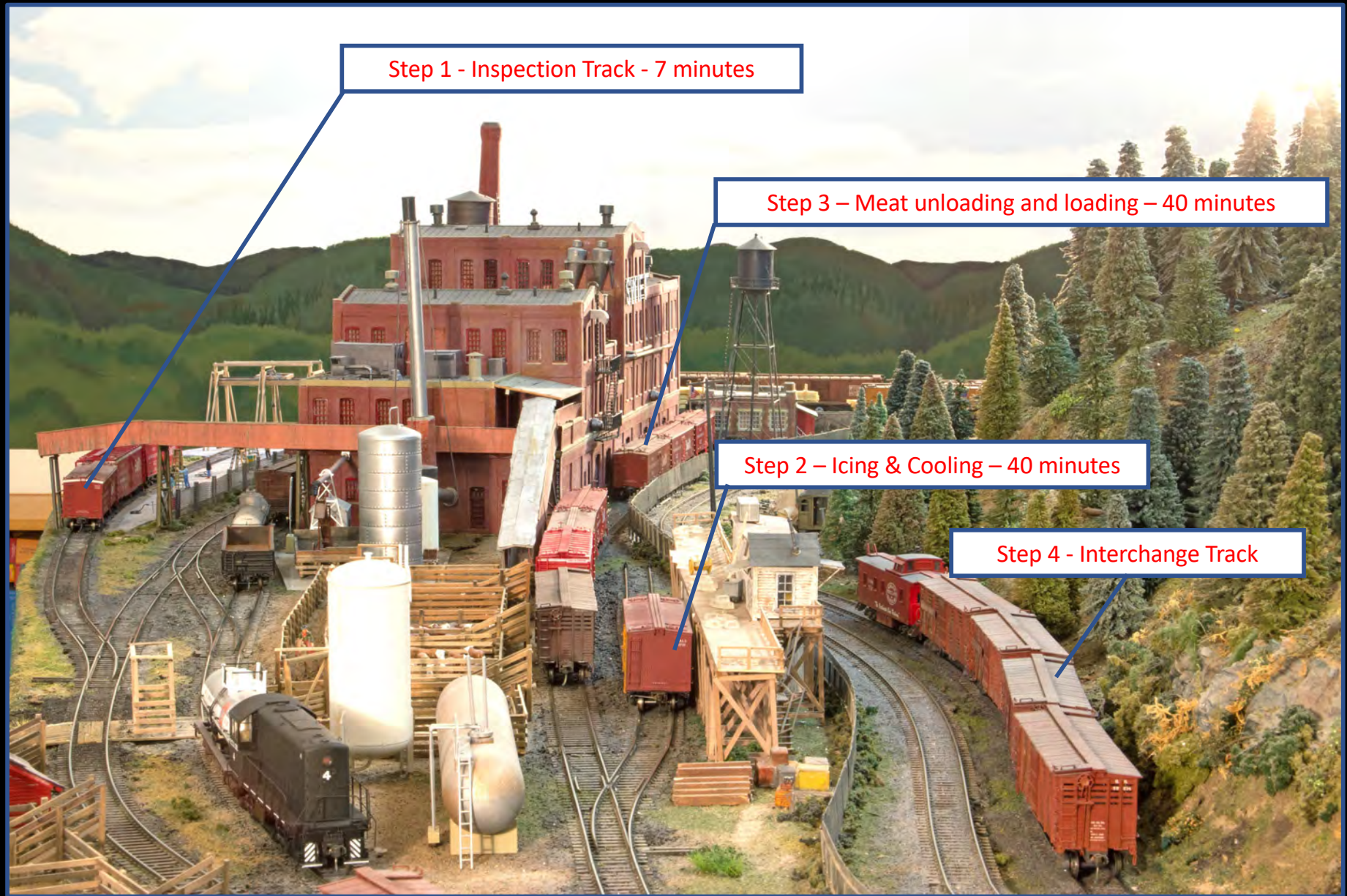

Operating Scheme – Reefer Movements

Decker Reefers

___1) URTC Inspection

___ Hold for Repair

___2) Cleaning

___3) Pre-cooling

___4) Icing

___5) Loading

___6) to yard

___7) to scale

___8) to yard for departure

Yardmaster remove this card when
car is placed on the DMX.

Special Orders:

ck 7 minutes

Step 3 –Meat unloading and loading – 40 minutes

Step 2 – Icing & Cooling – 40 minutes

Step 4 - Interchange Track

Operating Scheme – Reefer Movements

Step 1 - Inspection Track 7 minutes

Step 3 - Meat unloading and loading - 40 minutes

Step 2 - Icing & Cooling - 40 minutes

Step 4 - Interchange Track



– Reefer Movements

What to include – what to ignore

- Car Cleanout
- Sheep (mostly), Hogs
- Iced reefers and mechanical reefers
- Manure
- Hay and Feed
- ???????



The Future

Union Stockyard
traffic

Stock pen
walkways and
interior boards

Additional
interchange track
(NP, SPS, UP)

PFE Meat Reefers
#85001-85275

Meat Trains or
adding cars to
passing trains



The Future

Union Stockyard
traffic

Stock pen
walkways and
interior boards

Additional
interchange track
(NP, SPS, UP)

PFE Meat Reefers
#85001-85275



Information

RailwayBullShippersGroup@groups.io

- Routine input by Doug Harding and Bob Chaparro

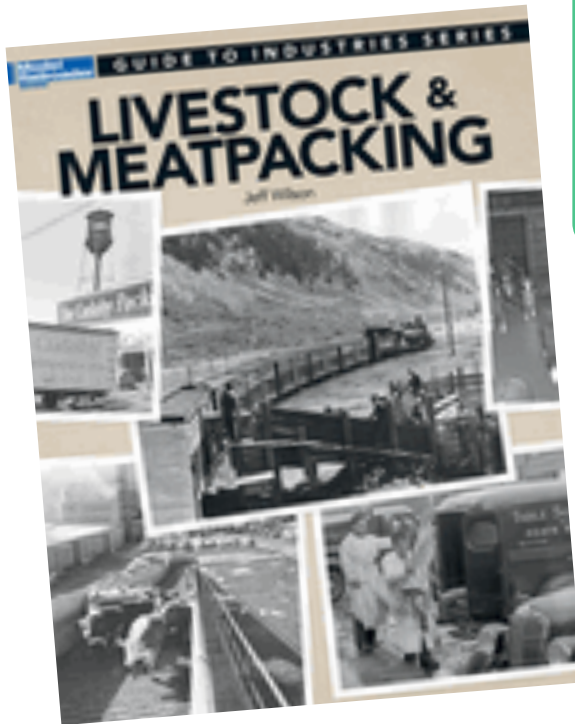

Doug Harding “Modeling a Meat Plant and Its Operations” *Railroad Model Craftsman* Oct & Bnov 2004

Livestock & Meatpacking by Jeff Wilson, Kalmbach, 2013